

1 | 00 Ground Floor - Partition Layout
1:100

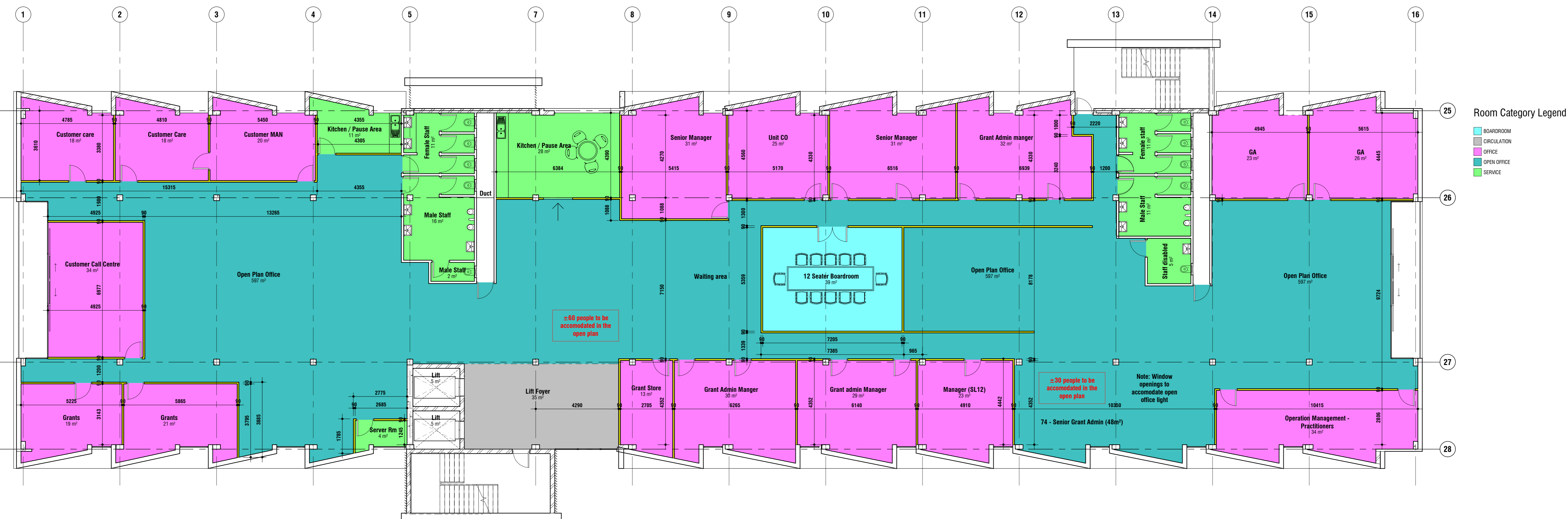

2 | 01 First Floor - Partition Layout
1:100

General Notes:
 1. All work is to be done in accordance with the National Building Regulations.
 2. All materials and workmanship are to comply with the relevant S.A.S. codes and/or the specified international codes where applicable in the Architectural specifications. Where relevant South African National Standards, British Standards, IES codes of practice, or Agreement Certificates applicable to the design exist, the recommendations and requirements of such documents to be considered a minimum standard for the works.
 3. The contractor shall in all aspects of the works comply with the provisions of the Occupational Health and Safety Act, 1993 (Act No. 95 of 1993) and any regulations promulgated in terms of that Act or the Factories Machinery and Building Works Act of 1941.
 4. The contractor shall set up, document and maintain a quality assurance and quality control system. In accordance with SANS 9001:150:2001, able to be checked to the satisfaction of the Architect, that all materials and workmanship, whatever their sources, meet the requirements of the Specification. Should the Contractor or any of his sub-contractors be certified to the SANS 9001 family of standards then monitor these works accordingly.
 5. This drawing must be read in conjunction with all the relevant drawings, schedules and specifications from TRS STUDIO and all other consultants related to the project.
 6. All portions of the work related to any service or consultant's information is to be done in accordance with the National Building Regulations.
 7. This drawing is not to be scaled. Figured dimensions to be used. All dimensions are in millimeters unless otherwise stated.
 8. All dimensions and levels must be checked on site by the contractor before starting work on hand.
 9. All work to be executed by competent persons qualified for the specific trade.
 10. This drawing is copyright reserved and remains the property of TRS STUDIO Architects.

11. NOTE THIS DRAWING MUST BE READ IN CONJUNCTION WITH THE TRS STUDIO ARCHITECTS ARCHITECTURAL SPECIFICATION (DOCUMENT SERIES 5600) ALL SECTIONS.

REVISIONS	
REV	DESCRIPTION
A	ISSUE FOR INFORMATION
B	GROUND FLOOR LAYOUT REVISED
C	ISSUES FOR APPROVAL
D	GROUND FLOOR LAYOUT REVISED AS PER DISCUSSION WITH TENANT
E	FIRST FLOOR REVISED AS PER TENANT REQUESTS
F	INTERNAL LAYOUTS ADJUSTED TO TENANT REQUESTS

KEY PLAN	

DRAWN BY: [Name] DATE: [Date]
 CHECKED BY: [Name] DATE: [Date]
 APPROVED BY: [Name] DATE: [Date]



tri studio ARCHITECTS

1, GateSide Avenue
 Durban
 Johannesburg
 1001
 Call: +27 (0)84 443 3330
 Email: scott@tristudio.co.za
 Reg. 2022/1461414/07

SASSA Space Planning
 FOR
Maponya Investment Holdings
 ERF 3139
 Sekama Road, Mmabatho
Mahikeng

PARTITION WALL PLANS GROUND TO FIRST FLOOR				
PROJECT	PHASE	DISCIPLINE	BLOCK/SERIES/SUFFIX	REVISION
BBB	01	AR	1100	F

DRAWN BY: Author CHECKED BY: Checker DATE: 06/23/21

© 2022 Scott Thompson/Document Services Office Model Control Office Information/Architect